

REVISIONS				
REV	DESCRIPTION	ECD #	DATE	APPROVED
A	CHG OPERATING TEMPTO 4° KELVIN	13-261	10/24/13	T. KUHN
B	SEPARATED O/D INTO 3 DISTINCT FREQ GROUPS	13-265	10/28/13	T. KUHN

### ELECTRICAL

FREQUENCY RANGE \_\_\_\_\_ DC-18GHz

ATTENUATION ACCURACY \_\_\_\_\_

0-6 dB	± 0.30
7-20 dB	± 0.50
21-30 dB	± 0.75
40 dB	± 1.00

### VSWR

DC - 4 GHz	1.15:1 MAX
4 - 12.4 GHz	1.25:1 MAX
12.4 - 18 GHz	1.35:1 MAX

POWER (AVG): \_\_\_\_\_ 2 WATTS  
DERATE FROM 25°C to 10% @ 125°

POWER (PEAK): \_\_\_\_\_ 500 WATTS  
At 5µ Second Pulse Width & 0.1% Duty Cycle

IMPEDANCE \_\_\_\_\_ 50 OHMS

OPERATING TEMP RANGE \_\_\_\_\_ 4° KELVIN TO +125°C  
150° C STORAGE

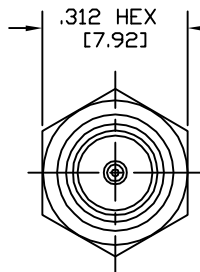

SMA PLUG PER MIL-STD-348

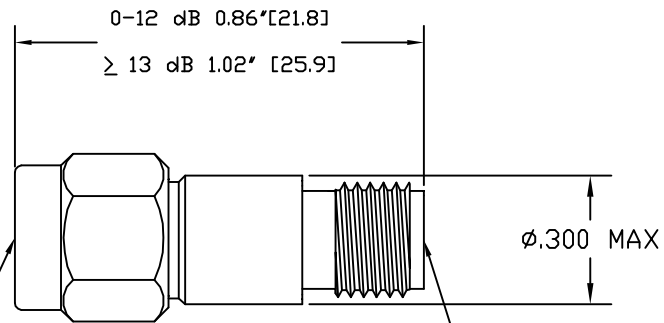

SMA JACK PER MIL-STD-348

### MECHANICAL

SMA CONNECTOR  
HOUSING \_\_\_\_\_ PASSIVATED STAINLESS STEEL  
CENTER CONTACT \_\_\_\_\_ GOLD PLATED BERYLLIUM COPPER  
RESISTIVE ELEMENT \_THIN FILM HYBRID ON 99.6% ALUMINA SUBSTRATE

CONNECTOR  
INTERFACE IAW MIL-STD-348 & MIL-PRF-39012

MATERIALS, FINISHES AND ENVIRONMENTAL CAPABILITIES  
DESIGNED TO MEET MIL-DTL-3933

ORDERING INFORMATION	
dB VALUES 2082:	1 dB Steps, 18 GHz 2082:
-00/-03 = 0 thru 3 dB	-6040-00 thru 03
-04/-06 = 4 thru 6 dB	-6041-04 thru 06
-07/-10 = 7 thru 10 dB	-6042-07 thru 10
-11/-12 = 11 and 12 dB	-6043-11 and 12
-13/-20 = 13 thru 20 dB	-6043-13 thru 20
-25, -30, and -40 dB	-6044-25, -30, or -40

FOR DFAR SPECIALTY COMPLIANT VERISONS,  
ADD "-DF" TO PART NUMBER.

DRAWING PRACTICES PER ANSI-Y-14.5 MIL-STD-883C & 1000	UNLESS OTHERWISE SPECIFIED TOLERANCES IN DIMENSIONS INCH DWG	DRAWN V. SHELBY 2/20/13	DATE 2/20/13
DIMENSIONS ARE IN INCHES AND APPLY BEFORE/AFTER PROCESSING	DECIMALS INCH DWG	CHECKED T. KUHN 2/20/13	DATE 2/20/13
SURFACE ROUGHNESS INCHES	.X" .03" [.76] .XXX" .010" [.25] .XXXX" .005 [.127] .XXXXX" .0005" [.013]	ENG APPR. T. KUHN 2/20/13	DATE 2/20/13
FINISH	ANGLES ±0°30'	THESE DRAWINGS AND SPECIFICATIONS ARE THE PROPERTY OF XMA CORP. OR OMNI SPECTRA AND SHALL NOT BE REPRODUCED, COPIED NOR USED - IN WHOLE OR IN PART - AS A BASIS FOR THE MANUFACTURE OR SALE OF OTHER ITEMS WITHOUT THE EXPRESS WRITTEN PERMISSION OF XMA CORP.	
SEE NOTES	REMOVE ALL BURRS/SHARP W/ BREAK / R OF .003" TO .0005" UNLESS OTHERWISE NOTED. DIAS CONCENTRIC <0.03 T.M.R.	SCALE 5:1	
SEE NOTES	NOTE: THIS DRAWING INCORPORATES THIRD ANGLE PROJECTION.	CAGE CODE 3HT76	
INTERPRET IAW ANSI Y14.5-1998	DO NOT SCALE PRINT	DRAWING NUMBER 2082-604X-dB-CRYO	

SIZE	CAGE CODE	DRAWING NUMBER	REV
C	3HT76	2082-604X-dB-CRYO	B



SMA FIXED ATTENUATOR  
M/F, 18 GHz, CRYOGENIC

SCALE	CAGE CODE	DRAWING NUMBER	REV
5:1	3HT76	2082-604X-dB-CRYO	B