

CATALOG NUMBER

B099-A99-10

MATERIAL AND FINISH

GPPO INSERT  
GPPO COLLET

CRES 303; PASSIVATED  
BeCu; NICKEL PLATE

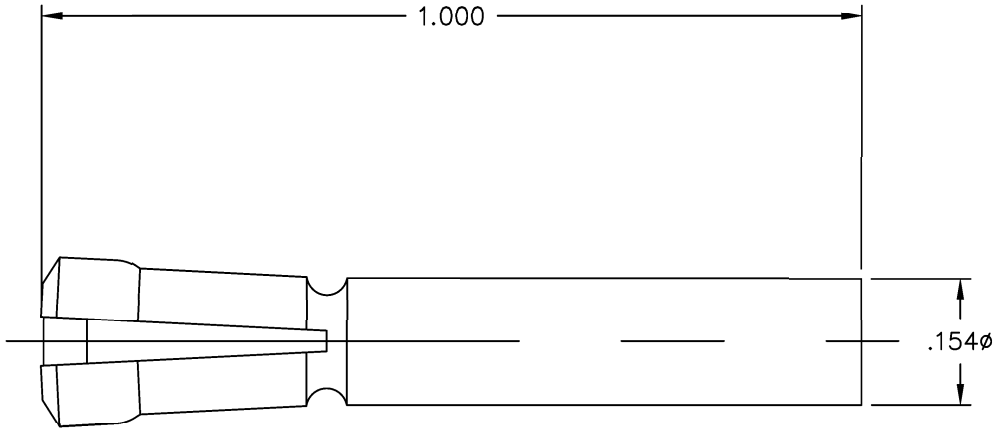
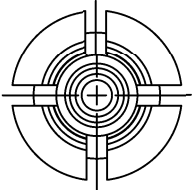
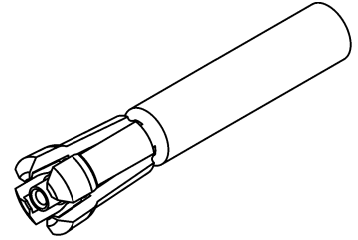

NOTES:

- GPPO TIP (B099-A99-11-TAB) AND HANDLE (L095-A99-01) ARE TO BE USED WITH COLLET.

This drawing and any data contained herein is the property of Corning Gilbert Inc., and constitutes and contains proprietary and confidential information. Neither receipt nor possession of this drawing confers or transfers any right to duplicate, use or disclose any information contained herein except as expressly authorized by Corning Gilbert Inc.

GPPO COLLET/INSERT

IDENT CODE:  
82316

REVISION: D

**Corning Gilbert Inc.**

SOURCE FILE: SK-2324

DWG. NO.: OL-B099-A99-10

ASSY. PROC.: -