

CATALOG NUMBER

9001-972-0

MATERIAL AND FINISH

HANDLE:

CRES 303; PASSIVATED

INSERT:

17-4 PH STAINLESS STEEL; PASSIVATED

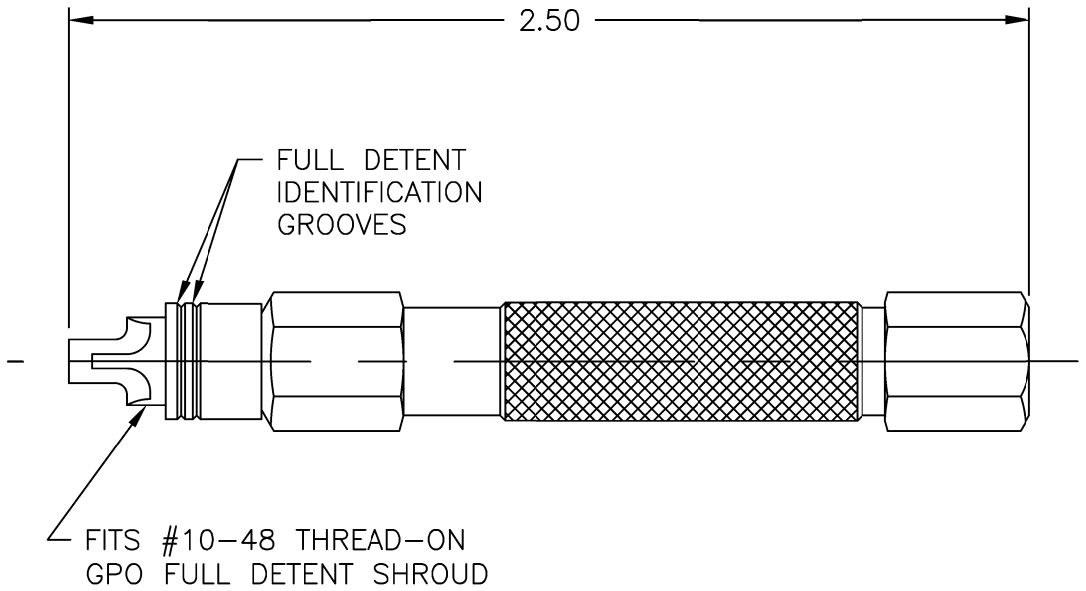
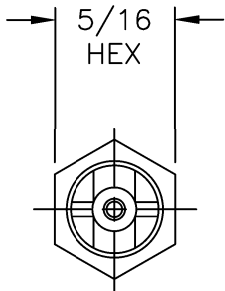
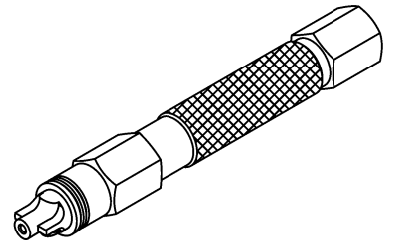

This drawing and any data contained herein is the property of Corning Gilbert Inc., and constitutes and contains proprietary and confidential information. Neither receipt nor possession of this drawing confers or transfers any right to duplicate, use or disclose any information contained herein except as expressly authorized by Corning Gilbert Inc.

GPO FULL DETENT
THREAD-ON
SHROUD DRIVER

IDENT CODE:
82316

REVISION: G

Corning Gilbert Inc.

SOURCE FILE: MECR# 350

DWG. NO.: OL-9001-972-0

ASSY. PROC.: -