

CATALOG NUMBER

R095-A99-02

MATERIAL AND FINISH

REAR INSERT, HEAD,
AND PLUNGER:

CRES 303; PASSIVATED

COLLET:

BeCu; NICKEL PLATE

FRONT BODY:

17-4 PH STAINLESS STEEL; PASSIVATED

SPRING:

STAINLESS STEEL

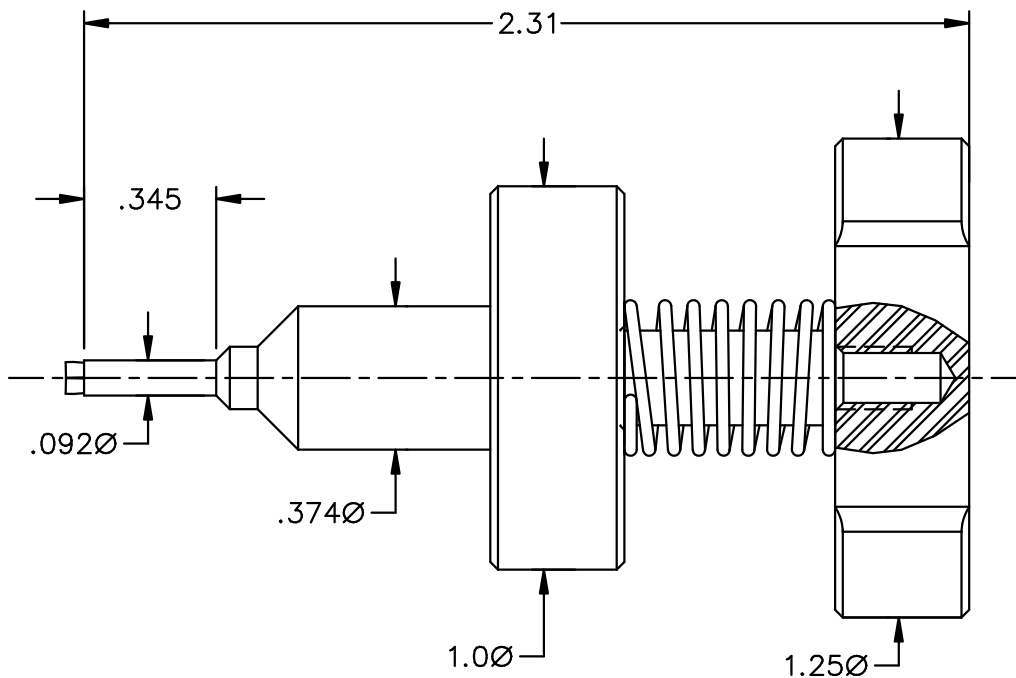
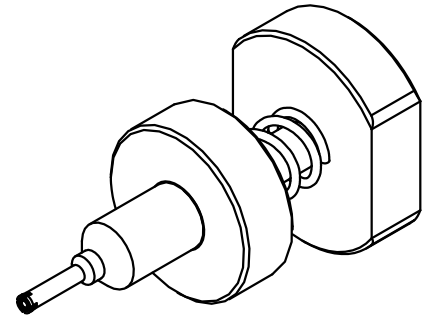

This drawing and any data contained herein is the property of Corning Gilbert Inc., and constitutes and contains proprietary and confidential information. Neither receipt nor possession of this drawing confers or transfers any right to duplicate, use or disclose any information contained herein except as expressly authorized by Corning Gilbert Inc.

G3PO LOW PROFILE
INSTALL/REMOVAL
TOOL

IDENT CODE:
82316

REVISION: A

Corning Gilbert Inc.

SOURCE FILE: SK-2358

DWG. NO.: OL-R095-A99-02

ASSY. PROC.: -

This document was created with Win2PDF available at <http://www.win2pdf.com>.
The unregistered version of Win2PDF is for evaluation or non-commercial use only.
This page will not be added after purchasing Win2PDF.