

Anritsu K Connector® 01-118 Cable Assembly Tool Kit

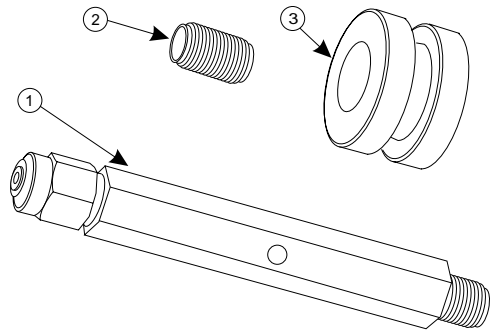

Figure 1. Model 01-118 Cable Assembly Tool

1. Purpose

The Model 01-118 Cable Assembly Tool Kit (Figure 1) provides tools that facilitate assembly of both male and female K101 cable connectors.

2. Tool List

Table 1 provides a listing of the tools in the 01-118 tool kit. The index numbers correspond with Figure 1, above.

Table 1. Tool List

Index Number	Name	Anritsu Part Number
1	Multipurpose Tool	B14850
2	Assembly Barrel	A14890
3	Fixture, Cable Bending	A14701

3. Use With the K101M Cable Connector

General instructions for assembling the K101M connector are provided in the instruction sheet included with the connector. Use of the multipurpose tool for bead installation, as specified in the Model K101M Instruction Sheet (10200-00017), is amplified below.

- Connect the male connector bead-pressing end of the multipurpose tool (Figure 2) to the coupling nut on the K101M connector.
- Tighten the K101M coupling nut to press the bead into place. The male pin should not move during this process.

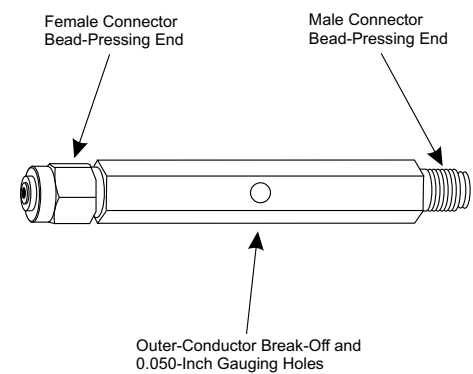

Figure 2. Multipurpose Tool

4. Use With The K101F Cable Connector

Instructions for using the cable-bending fixture and the multipurpose tool in assembling the K101F cable connector are provided in the Model K101F Instruction Sheet (10200-00014).

P/N: 10200-00010
Revision: E
Printed: August 2003
Copyright © 1985-2003 Anritsu Company

Front Panel
Cut Size: 4.25" x 10.50:

Rear Panel
Cut Size: 4.25" x 10.50:

