

CATALOG NUMBER

9001-928-3

## MATERIAL AND FINISH

REAR INSERT  
AND HEAD:

CRES 303; PASSIVATED

COLLET:

BeCu; BRIGHT ALLOY PLATE

BODY AND SLEEVE:

17-4 PH STAINLESS STEEL; PASSIVATED

SPRING:

300 SERIES STAINLESS STEEL

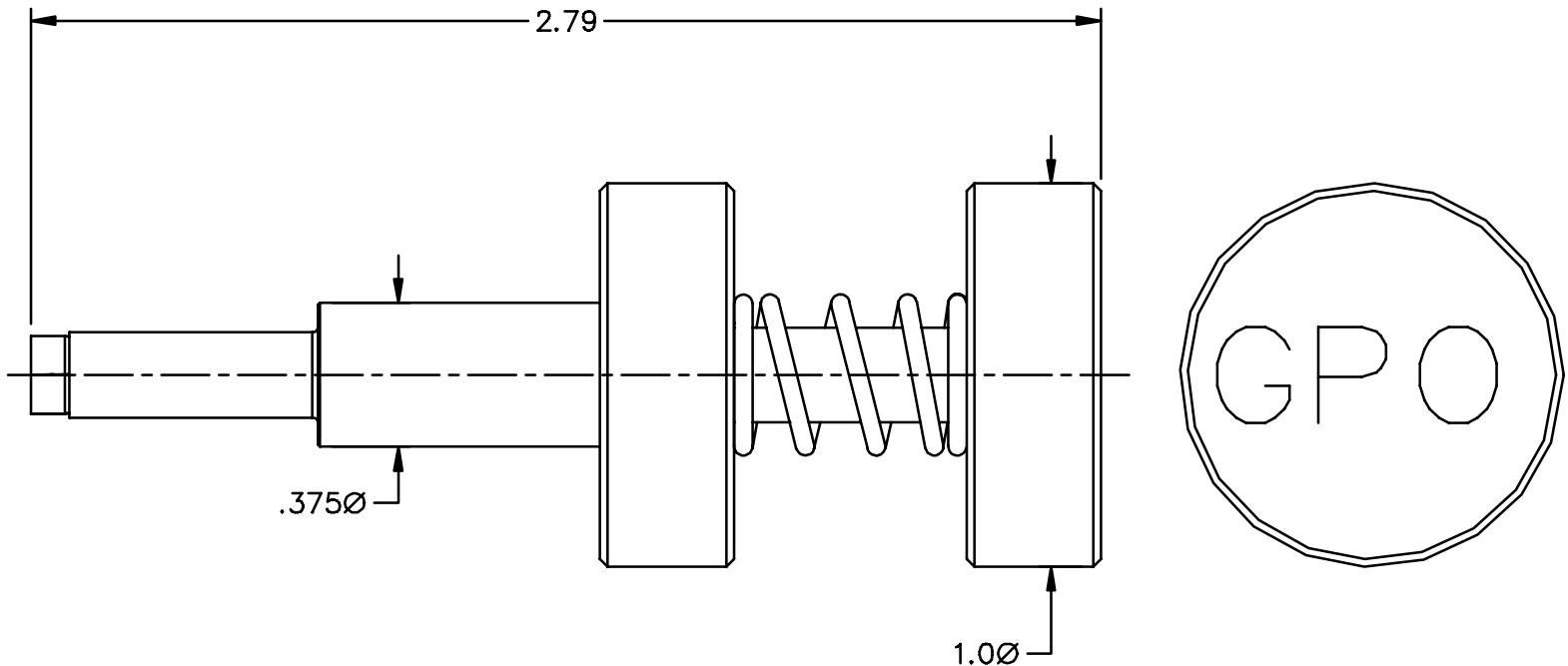
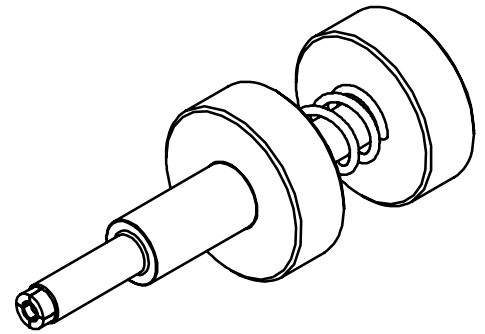

This drawing and any data contained herein is the property of Corning Gilbert Inc., and constitutes and contains proprietary and confidential information. Neither receipt nor possession of this drawing confers or transfers any right to duplicate, use or disclose any information contained herein except as expressly authorized by Corning Gilbert Inc.

GPO INSTALL/REMOVAL TOOL

IDENT CODE:  
82316

REVISION: H

**Corning Gilbert Inc.**

SOURCE FILE: MECR# 628, SK-1591

DWG. NO.:

OL-9001-928-3

ASSY. PROC.:

-