

***** THIS DRAWING AND ITS CONTENTS ARE THE SOLE PROPERTY OF PRECISION CONNECTOR INC. AND ARE SUBJECT TO CHANGE WITHOUT NOTICE UNLESS OTHERWISE SPECIFIED *****

REV.	DESCRIPTION	DATE	BY	APPVD
A	INITIAL RELEASE	08/15/07	MJK	MJK

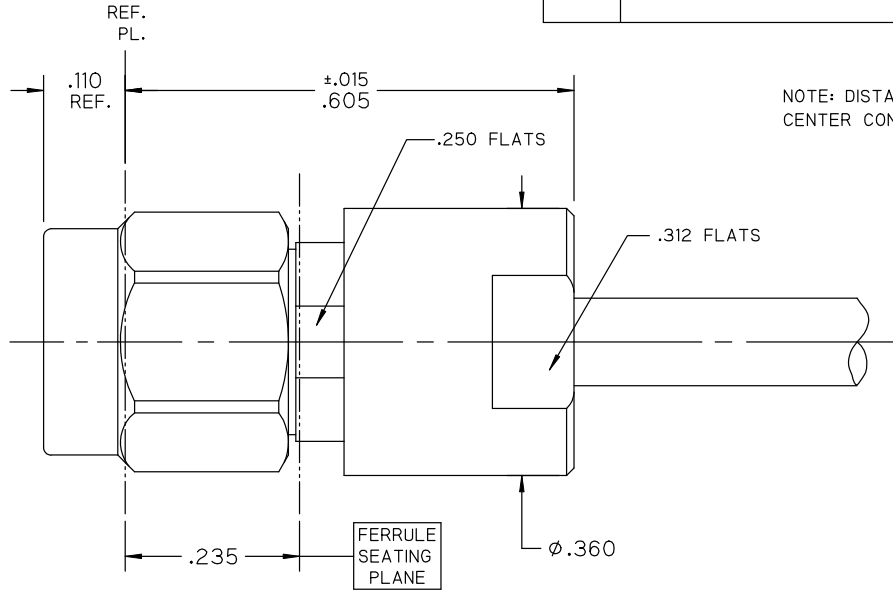

NOTE: DISTANCE FROM END OF CABLE CENTER COND. TO REF. PL. IS .135

NOTES :

1.0 MATERIALS:

- 1.1 BODY, COUPLING & CLAMP NUTS: STEEL, CORROSION RESISTANT PER ASTM-A582, UNS NO. S30300.
- 1.2 CENTER COND.: BERYLLIUM COPPER PER ASTM-B196, UNS C17300.
- 1.3 SOLDER FERRULE: BRASS PER ASTM-B16, UNS C36000.
- 1.4 LOCK RING: BERYLLIUM COPPER PER ASTM-B197, UNS C17200.
- 1.5 GASKET: SILICONE RUBBER PER A-A-59588.
- 1.6 INSULATORS: PTFE FLUOROCARBON PER ASTM-D1710.

2.0 FINISHES:

- 2.1 BODY, COUPLING & CLAMP NUTS: PASSIVATE PER SAE-AMS-2700.
- 2.2 CENTER CONTACT: GOLD PLATE PER ASTM-B488, 50 MICROINCHES MIN. THK. OVER ELECTROLYTIC NICKEL PLATE PER ASTM-B689 50 MICROINCHES MIN. THK.
- 2.3 SOLDER FERRULE: ELECTROLESS NICKEL PLATE PER ASTM-B733, 200 MICROINCHES MIN. THK.
- 2.4 GASKET, LOCK RING & DIELECTRICS: NONE.
- 3.0 INTERFACE: SMA PLUG PER PER MIL-STD-348, FIGURE 310-1.



TOLERANCES UNLESS OTHERWISE SPECIFIED		DRAWN BY: MJK		TITLE : OUTLINE DRAWING, SMA PLUG FOR SEMFLEX SW110 CABLE		
.XX	± .02	DATE: 08/15/07		CAGE CODE	SCALE	SHEET NO.
.XXX	± .005	4MJR5		5:1	1 OF 1	DRAWING NUMBER
.XXXX	± .0005					3205-0L
ANGLES	± 2°					REV
						A