

***** THIS DRAWING AND ITS CONTENTS ARE THE SOLE PROPERTY OF PRECISION CONNECTOR INC. AND ARE SUBJECT TO CHANGE WITHOUT NOTICE UNLESS OTHERWISE SPECIFIED *****

REV.	DESCRIPTION	DATE	BY	APPVD
A	INITIAL RELEASE	04/23/10	MJK	MJK

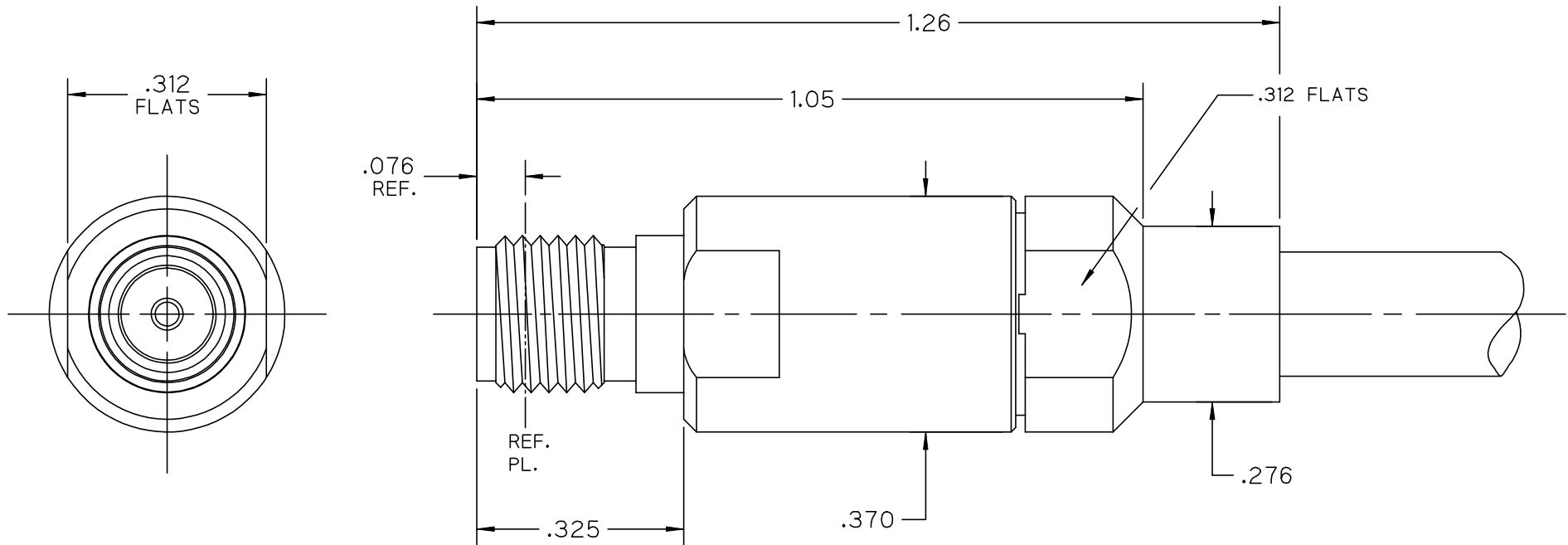

NOTE: DISTANCE FROM END OF CABLE CENTER COND. TO REF. PL. IS .325

NOTES :

1.0 MATERIALS:

- 1.1 BODY & CLAMP NUT: STEEL, CORROSION RESISTANT PER ASTM-A582, UNS NO. S30300.
- 1.2 CENTER COND.: BERYLLIUM COPPER PER ASTM-B196, UNS C17300.
- 1.3 SOLDER FERRULE: BRASS PER ASTM-B16, UNS C36000.
- 1.4 O-RING: SILICONE RUBBER PER A-A-59588.
- 1.5 INSULATOR: PTFE FLUOROCARBON PER ASTM-D1710.
- 1.6 DIELECTRIC STOP: POLYETHERIMIDE THERMOPLASTIC (ULTEM 1000) PER ASTM-D5205.

2.0 FINISHES:

- 2.1 CENTER CONTACT & SOLDER FERRULE: GOLD PLATE PER ASTM-B488, 50 MICROINCHES MIN. THK. OVER ELECTROLYTIC NICKEL PLATE PER ASTM-B689 50 MICROINCHES MIN. THK.
 - 2.2 BODY & CLAMP NUT: PASSIVATE PER SAE-AMS-2700.
 - 2.3 O-RING & DIELECTRICS: NONE.
- 3.0 INTERFACE PER PCI-SMAJ.



TOLERANCES UNLESS OTHERWISE SPECIFIED		DRAWN BY: MJK		DESC.: SMA JACK, SOLDER CLAMP FOR HARBOUR LL142 CABLE		
.XX ± .02		DATE: 04/23/10				
.XXX ± .005		CAGE CODE		SCALE	SHEET NO.	DRAWING NUMBER
.XXXX ± .0005		4MJR5		4:1	1 OF 1	3294-0L
ANGLES ± 2°						REV
						A