

CATALOG NUMBER

A014-F71-01

MATERIAL AND FINISH

HOUSING, CENTER CONTACT, AND EMI/ANTI-ROCK RING:

BeCu; GOLD PLATE 50-100 MICROINCHES OVER NICKEL PLATE 50 MICROINCHES MIN.

DIELECTRIC:

VIRGIN PTFE

DIELECTRIC STOP:

TORLON (POLYAMIDE-IMIDE)

SHEATH:

HEAT SHRINKABLE TUBING

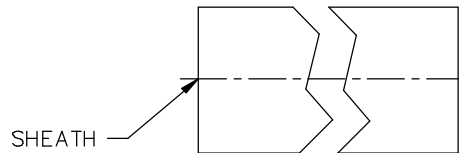
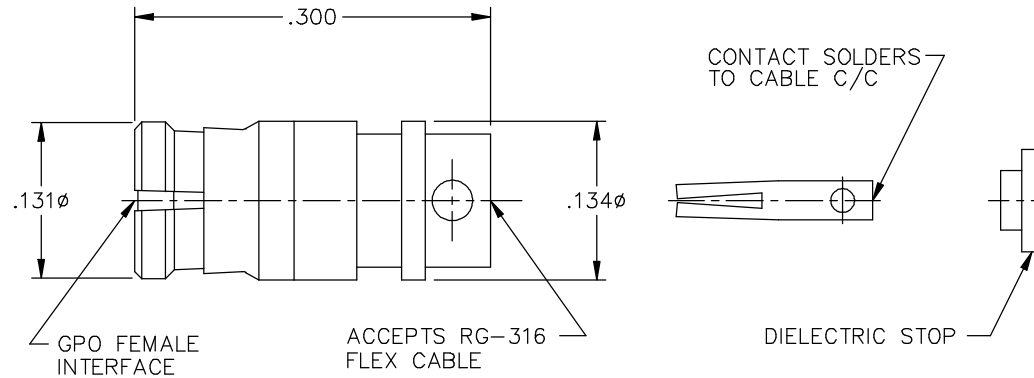
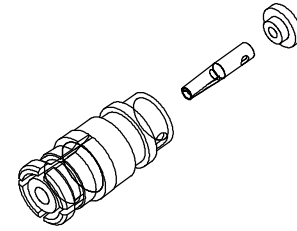

This drawing and any data contained herein is the property of Corning Gilbert Inc., and constitutes and contains proprietary and confidential information. Neither receipt nor possession of this drawing confers or transfers any right to duplicate, use or disclose any information contained herein except as expressly authorized by Corning Gilbert Inc.

GPO FEMALE STRAIGHT TO RG-316 FLEX CABLE SOLDER ATTACH C/C

IDENT CODE:
82316

REVISION: B

Corning Gilbert Inc.

SOURCE FILE: MECR# 2415

DWG. NO.: OL-A014-F71-01

ASSY. PROC.: IS-7804-1