

CATALOG NUMBER	"A" INTERFACE
1B3F2-0503-01	FULL DETENT
1B5F2-0503-01	SMOOTH BORE

MATERIAL AND FINISH

GPPO HOUSING,  
PLUG HOUSING, AND  
COUPLING NUT:

CRES 303; PASSIVATED

PIN CONTACT:

BeCu; GOLD PLATE 50-100 MICROINCHES  
OVER NICKEL PLATE 50 MICROINCHES MIN.

RETAINING RING:

BeCu

DIELECTRICS:

VIRGIN PTFE

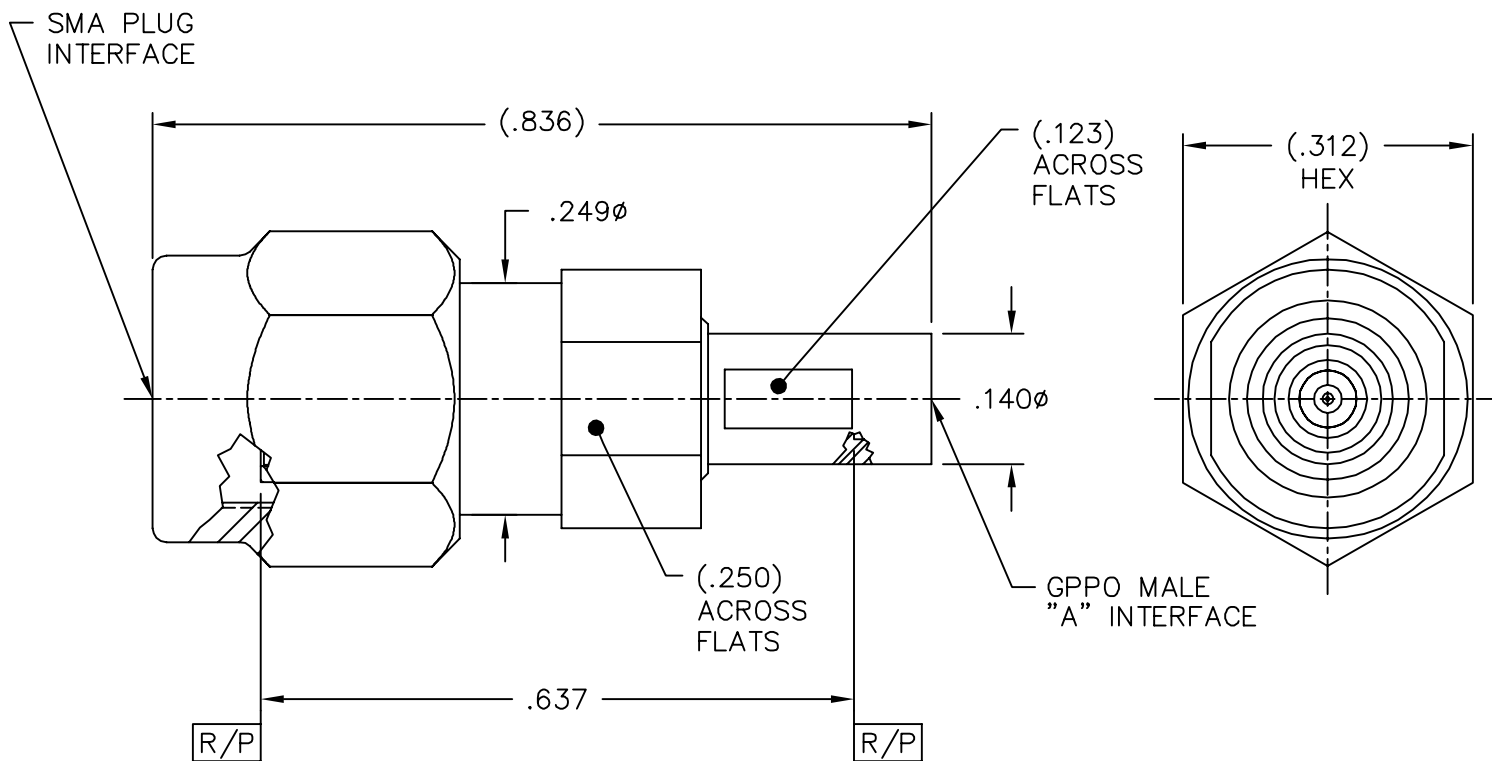
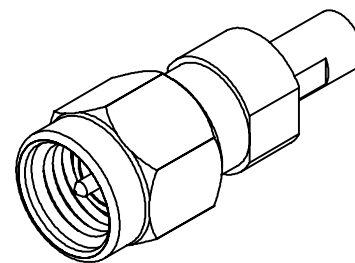

This drawing and any data contained herein is the property of Corning Gilbert Inc., and constitutes and contains proprietary and confidential information. Neither receipt nor possession of this drawing confers or transfers any right to duplicate, use or disclose any information contained herein except as expressly authorized by Corning Gilbert Inc.

GPPO MALE TO SMA  
PLUG ADAPTER  
(TAB DETENT)

IDENT CODE:  
82316

REVISION: E

**Corning Gilbert Inc.**

SOURCE FILE: MECR# 2384

DWG. NO.: OL-1BXF2-0503-01

ASSY. PROC.: -