

## CATALOG NUMBER

A1A1-0001-09

## MATERIAL AND FINISH

SPRING: 302 SS  
 CENTER CONTACTS AND HOUSINGS: BeCu; GOLD PLATE 75 MICRINCHES TYPICAL  
 OVER NICKEL PLATE 100 MICRINCHES TYPICAL  
 DIELECTRICS: VIRGIN PTFE  
 O-RING: SILICONE RUBBER  
 OUTER SHELL: CRES 303; PASSIVATED

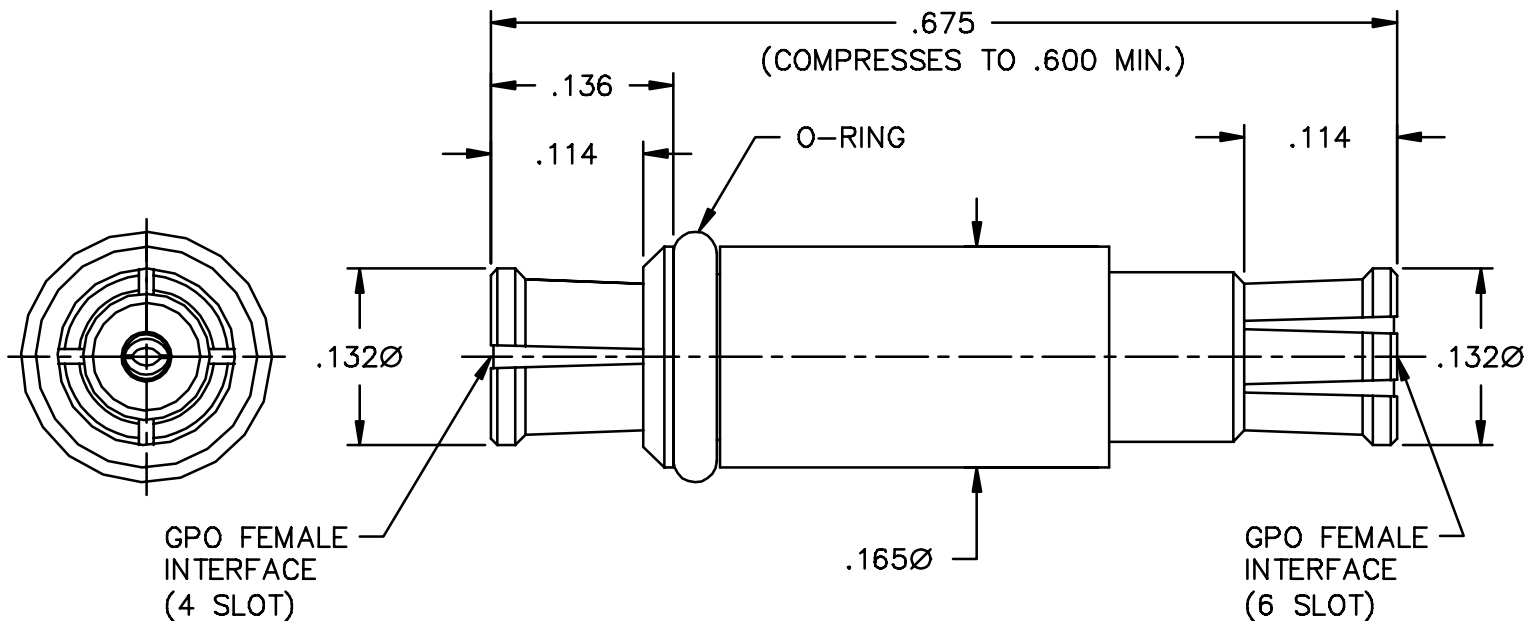
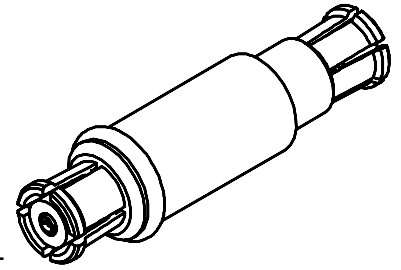

## NOTES:

1. SPRING PRELOAD SHALL BE GREATER THAN FORCE REQUIRED TO ENGAGE 6 SLOT END INTO GPO SMOOTH BORE INTERFACE.
2. SPRING PRELOAD: 1.0 lb NOMINAL  
 SPRING RATE: 15.4 lbs/in.

This drawing and any data contained herein is the property of Corning Gilbert Inc., and constitutes and contains proprietary and confidential information. Neither receipt nor possession of this drawing confers or transfers any right to duplicate, use or disclose any information contained herein except as expressly authorized by Corning Gilbert Inc.

GPO BLINDMATE  
 INTERCONNECT  
 (SELF ADJUSTING)

IDENT CODE:  
 82316

REVISION: H

**Corning Gilbert Inc.**

SOURCE FILE: SK-1700

DWG. NO.: OL-A1A1-0001-09

ASSY. PROC.: -