

# ELECTRICAL SPECIFICATIONS

FREQUENCY RANGE (GHz):	0.800-2.200
COUPLING:	* NOM $\pm 1.75$ dB
(INCLUDES ALL VARIATIONS)	
IMPEDANCE (NOMINAL):	50 Ohms
VSWR (MAX):	SEE TABLE
PORT-TO-PORT TRACKING (MAX):	0.5 dB
DIRECTIVITY (MIN):	SEE TABLE
INSERTION LOSS (MAX):	0.25 dB
(EXCLUDING COUPLED POWER)	
POWER RATING: AVG:	SEE TABLE
PEAK:	10 kWATTS

\* NOMINAL COUPLING VALUES OF 10, 20, 30 & 40 dB AVAILABLE

PART NO.	COUPLING (dB) (NOMINAL)	DIRECTIVITY (dB) (MIN)	VSWR (MAX)	POWER RATING (WATTS)
722N-10-1.500V	10	22	1.20:1	25
722N-20-1.500V	20	25	1.15:1	250
722N-30-1.500V	30	25	1.15:1	500
722N-40-1.500V	40	22	1.15:1	500

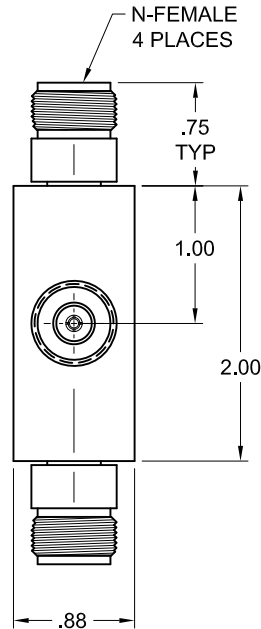

# MECHANICAL SPECIFICATIONS

CONNECTORS:	N-MALE, BRASS, ALBALOY PLATE
CONNECTOR PINS:	BERYLLIUM COPPER, GOLD PLATE
HOUSING:	ALUMINUM, RoHS COMPLIANT IRIDITE
INSULATORS:	PTFE, VIRGIN ELECTRICAL GRADE
TEMPERATURE:	-55°C TO +85°C
WEIGHT (NOMINAL):	6.4 oz.

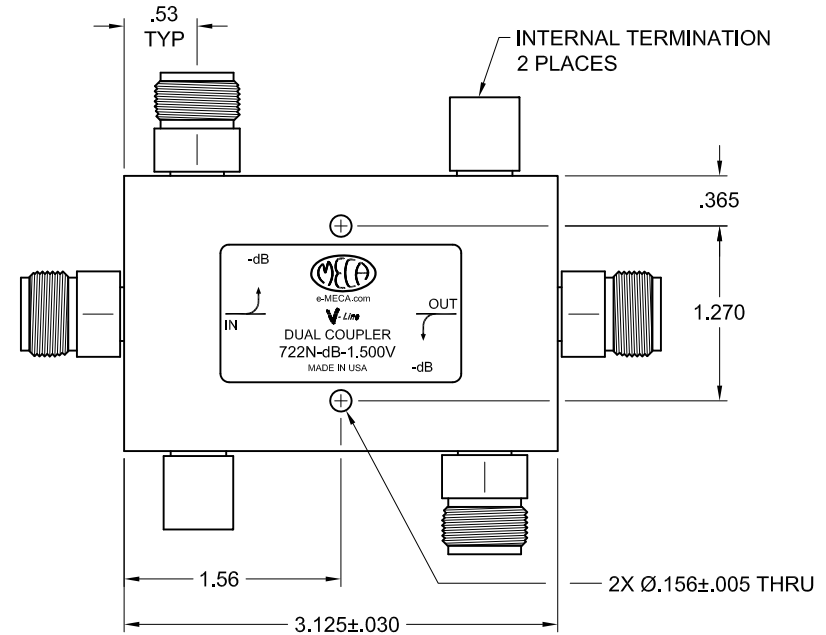

C		SEE DCN #130604-7	06/12/13	NL	RR
B		SEE DCN #060716-4	02/16/06		JL
LTR	PG	DESCRIPTION	DATE	DR	APP

MATERIAL: SEE ABOVE		UNLESS OTHERWISE SPECIFIED, DIMENSIONS ARE IN INCHES	
FINISH: SEE ABOVE		TOLERANCES 2 PLACES: $\pm .02$ 3 PLACES: $\pm .010$ ANGLES: N/A	
DRAWN: RWA	DATE: 06/11/02	TIR: N/A	
APPROVED: MJD	DATE: 06/11/02	SCALE: NTS	SIZE A
		SHEET: 1 OF 1	



**ELECTRONICS, INC.**  
DENVER, NEW JERSEY  
e-MECA.com



**TITLE**  
DUAL DIRECTIONAL COUPLER,  
N-FEMALE

CAGE CODE NO. 22424	DRAWING NO. 722N-dB-1.500V	REV C
------------------------	-------------------------------	----------