

REV.	DATE	DESCRIPTION
NC	05/24/05	INITIAL RELEASE
A	08/13/06	UPDATE DRAWING FORMAT

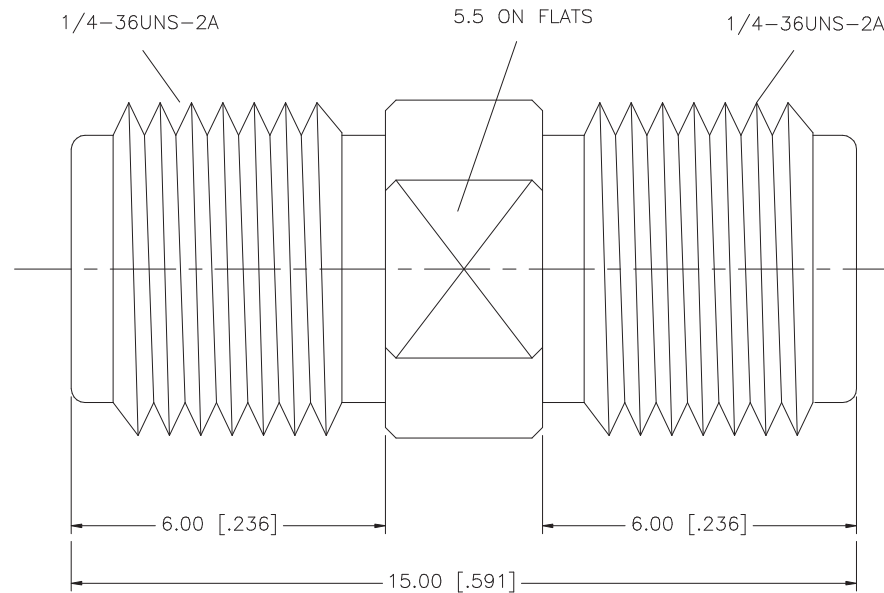

8					UNLESS OTHERWISE SPECIFIED DIMENSIONS ARE IN MILLIMETERS. DIMENSIONS IN [] ARE IN INCHES AND FOR CUSTOMER REFERENCE ONLY.	APPROVALS	DATE	Amphenol Connex				
7						DRAWN G.R.S.	08/13/06				PART DESCRIPTION	SMA FEMALE TO FEMALE ADAPTER -
6					UNLESS OTHERWISE SPECIFIED TOLERANCES FOR MILLIMETERS ARE: 0.5 - 8mm ± 0.20mm 8 - 30mm ± 0.40mm 30 - 120mm ± 0.50mm	CHECKED		PART NO.	132169			
5					UNLESS OTHERWISE SPECIFIED TOLERANCES FOR INCHES ARE: .020 - .315 = ± 0.007" .315 - 1.180 = ± 0.015" 1.180 - 4.724 = ± 0.020"	ISSUED		DWG. NO.				132169.DWG
4						SHEET 1 OF 1						
3	CONTACT PIN	BER. COPPER	GOLD	1		CAD FILE	C:/132/132169.DWG					
2	INSULATOR	TEFLON	NATURAL	1								
1	BODY	BRASS	GOLD	1								
	DESCRIPTION	MATERIAL	FINISH	QTY	DO NOT SCALE DRAWING							