

DATE REVISED: 9/29/00

CATALOG NUMBER	INTERFACE	USED ON SHROUD P/N
A097-A99-01	FULL DETENT	A003-A23-01
A097-A99-02	LIMITED DETENT	A003-A24-01
A097-A99-03	SMOOTH BORE	A003-A25-01

MATERIAL AND FINISH

HANDLE: CRES 303; PASSIVATED  
INSERT: 17-4 PH STAINLESS STEEL; PASSIVATED

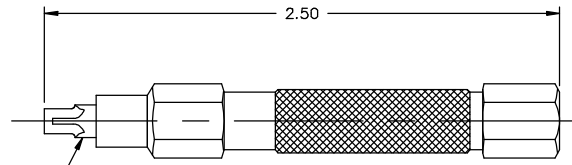
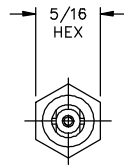
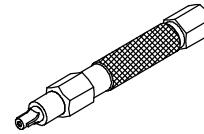

FITS #10-48 THREAD-IN GPO SHROUD

GPO THREAD-IN SHROUD DRIVER

IDENT CODE:  
82316

REVISION: A

GILBERT ENGINEERING

SOURCE FILE: MECR# 1584

DWG. NO.: OL-A097-A99-TAB

ASSY. PROC.: -